

Programmes After Market Services NSD-5 Series Transceivers

4. Parts List

Contents

	Page No
Exploded View NSD-5	5
Parts List	5
NSD-5FX — EDMS Issue 6.0 Code: 0202013	5

Exploded View NSD-5

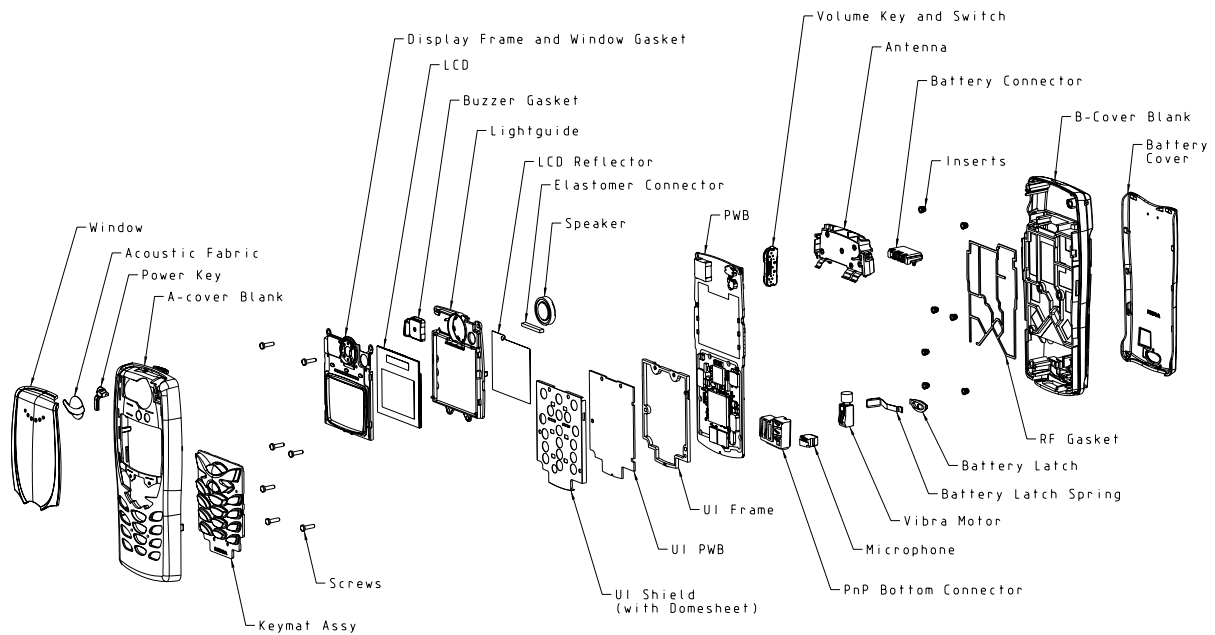

Parts List

NSD-5FX – EDMS Issue 6.0 Code: 0202013

ITEM	CODE	SIDE	X	Y	DESCRIPTION	VALUE	TYPE
R100	1430812	Top	P	3	chip resistor	0W06 220K J	0402
R101	1430778	Top	Q	3	chip resistor	0W06 10K J	0402
R120	1430726	Top	P	3	chip resistor	0W06 100R J	0402
R122	1620027	Top	O	3	res network	0W06 2x47R J	0404
R123	1620027	Top	O	3	res network	0W06 2x47R J	0404
R124	1430796	Top	P	3	chip resistor	0W06 47K J	0402
R125	1430770	Top	O	3	chip resistor	0W06 4K7 J	0402
R126	1430812	Top	P	3	chip resistor	0W06 220K J	0402
R131	1430726	Top	O	3	chip resistor	0W06 100R J	0402
R133	1430700	Top	O	7	chip resistor	0W06 10R J	0402
R134	1430778	Top	O	7	chip resistor	0W06 10K J	0402
R135	1430762	Top	N	7	chip resistor	0W06 2K2 J	0402

ITEM	CODE	SIDE	X	Y	DESCRIPTION	VALUE	TYPE
R136	1430762	Top	0	7	chip resistor	0W06 2K2 J	0402
R137	1430762	Top	0	8	chip resistor	0W06 2K2 J	0402
R140	1430786	Top	0	7	chip resistor	0W06 18K J	0402
R141	1430796	Top	0	7	chip resistor	0W06 47K J	0402
R142	1430778	Top	Q	3	chip resistor	0W06 10K J	0402
R143	1430778	Top	Q	3	chip resistor	0W06 10K J	0402
R144	1430115	Top	K	8	chip resistor	0W06 2K2 F 200 ppm	0402
R145	1430115	Top	K	8	chip resistor	0W06 2K2 F 200 ppm	0402
R146	1430754	Top	0	3	chip resistor	0W06 1K0 J	0402
R162	1430778	Top	0	2	chip resistor	0W06 10K J	0402
R175	1430690	Top	R	6	chip jumper	0R0	0402
R200	1430764	Bottom	N	5	chip resistor	0W06 3K3 J	0402
R201	1430804	Bottom	0	4	chip resistor	0W06 100K J	0402
R202	1430788	Bottom	0	3	chip resistor	0W06 22K J	0402
R203	1430796	Bottom	0	3	chip resistor	0W06 47K J	0402
R205	1430778	Top	N	5	chip resistor	0W06 10K J	0402
R241	1430137	Bottom	Q	4	chip resistor	0W06 1K0 F 200 ppm	0402
R242	1430871	Bottom	Q	4	chip resistor	0W06 82K F	0402
R243	1430215	Bottom	Q	4	chip resistor	-W06 68K F 200 ppm	0402
R244	1430718	Bottom	Q	7	chip resistor	0W06 47R J	0402
R245	1430796	Bottom	S	6	chip resistor	0W06 47K J	0402
R250	1430726	Bottom	Q	6	chip resistor	0W06 100R J	0402
R251	1430718	Bottom	Q	6	chip resistor	0W06 47R J	0402
R260	1430744	Bottom	0	6	chip resistor	0W06 470R J	0402
R261	1430744	Bottom	Q	6	chip resistor	0W06 470R J	0402
R270	1430744	Bottom	0	6	chip resistor	0W06 470R J	0402
R271	1430744	Bottom	Q	5	chip resistor	0W06 470R J	0402
R272	1430137	Bottom	Q	5	chip resistor	0W06 1K0 F 200 ppm	0402
R273	1430121	Bottom	Q	5	chip resistor	0W06 22K F 200 ppm	0402
R274	1430826	Bottom	Q	5	chip resistor	0W06 680K J	0402
R275	1430804	Top	0	3	chip resistor	0W06 100K J	0402
R280	1430804	Bottom	P	8	chip resistor	0W06 100K J	0402

ITEM	CODE	SIDE	X	Y	DESCRIPTION	VALUE	TYPE
R282	1430760	Bottom	P	8	chip resistor	0W06 1K8 J	0402
R283	1430744	Bottom	P	7	chip resistor	0W06 470R J	0402
R284	1430744	Bottom	P	7	chip resistor	0W06 470R J	0402
R285	1430744	Bottom	P	8	chip resistor	0W06 470R J	0402
R286	1430744	Bottom	P	8	chip resistor	0W06 470R J	0402
R287	1430760	Bottom	P	8	chip resistor	0W06 1K8 J	0402
R290	1430712	Bottom	Q	8	chip resistor	0W06 27R J	0402
R291	1430712	Bottom	Q	8	chip resistor	0W06 27R J	0402
R292	1430718	Bottom	Q	7	chip resistor	0W06 47R J	0402
R301	1825005	Bottom	Q	4	chip varistor	VWM14V VC30V	0805
R302	1430700	Bottom	R	3	chip resistor	0W06 10R J	0402
R310	1419003	Bottom	P	3	chip resistor	0W5 0R22 J 200ppm	1210
R311	1430726	Bottom	P	4	chip resistor	0W06 100R J	0402
R315	1430796	Top	O	3	chip resistor	0W06 47K J	0402
R316	1430770	Top	N	3	chip resistor	0W06 4K7 J	0402
R320	1430853	Top	M	6	chip resistor	0W06 2M2 J	0402
R321	1430808	Top	M	6	chip resistor	0W06 150K J	0402
R322	1430800	Top	M	6	chip resistor	0W06 68K J	0402
R323	1430708	Top	M	4	chip resistor	0W06 18R J	0402
R330	1430778	Top	N	6	chip resistor	0W06 10K J	0402
R331	1430804	Top	M	6	chip resistor	0W06 100K J	0402
R332	1430804	Top	M	7	chip resistor	0W06 100K J	0402
R333	1430830	Top	N	6	chip resistor	0W06 1M0 J	0402
R334	1430187	Top	L	6	chip resistor	0W06 47K F 200 ppm	0402
R335	1430145	Top	L	6	chip resistor	0W06 100K F 200ppm	0402
R336	1430796	Top	L	6	chip resistor	0W06 47K J	0402
R337	1430830	Top	L	6	chip resistor	0W06 1M0 J	0402
R338	1430778	Top	L	6	chip resistor	0W06 10K J	0402
R339	1430778	Top	L	6	chip resistor	0W06 10K J	0402
R410	1413829	Bottom	S	8	chip resistor	0W1 10 R J	0805
R411	1413829	Bottom	S	6	chip resistor	0W1 10 R J	0805
R420	1430784	Top	M	7	chip resistor	0W06 15K J	0402

ITEM	CODE	SIDE	X	Y	DESCRIPTION	VALUE	TYPE
R421	1430784	Top	M	8	chip resistor	0W06 15K J	0402
R424	1430778	Top	N	4	chip resistor	0W06 10K J	0402
R425	1413829	Bottom	S	6	chip resistor	0W1 10 R J	0805
R430	1430778	Top	L	7	chip resistor	0W06 10K J	0402
R440	1430754	Top	Q	7	chip resistor	0W06 1K0 J	0402
R441	1430754	Top	Q	7	chip resistor	0W06 1K0 J	0402
R442	1430754	Top	P	7	chip resistor	0W06 1K0 J	0402
R443	1430754	Top	Q	7	chip resistor	0W06 1K0 J	0402
R444	1430754	Top	P	7	chip resistor	0W06 1K0 J	0402
R445	1430754	Top	Q	7	chip resistor	0W06 1K0 J	0402
R446	1430754	Top	Q	7	chip resistor	0W06 1K0 J	0402
R447	1430754	Top	P	7	chip resistor	0W06 1K0 J	0402
R448	1430754	Top	O	7	chip resistor	0W06 1K0 J	0402
R449	1430754	Top	P	7	chip resistor	0W06 1K0 J	0402
R501	1430728	Bottom	H	3	chip resistor	0W06 120R J	0402
R502	1430700	Bottom	G	4	chip resistor	0W06 10R J	0402
R503	1430744	Bottom	I	3	chip resistor	0W06 470R J	0402
R504	1430700	Bottom	G	3	chip resistor	0W06 10R J	0402
R505	1430770	Bottom	I	3	chip resistor	0W06 4K7 J	0402
R506	1430693	Bottom	I	4	chip resistor	0W06 5R6 J	0402
R507	1430693	Bottom	J	4	chip resistor	0W06 5R6 J	0402
R508	1430700	Bottom	J	4	chip resistor	0W06 10R J	0402
R509	1430700	Bottom	J	4	chip resistor	0W06 10R J	0402
R510	1430762	Bottom	J	4	chip resistor	0W06 2K2 J	0402
R511	1430762	Bottom	K	4	chip resistor	0W06 2K2 J	0402
R512	1430700	Bottom	L	3	chip resistor	0W06 10R J	0402
R513	1430804	Bottom	M	2	chip resistor	0W06 100K J	0402
R514	1430726	Bottom	L	5	chip resistor	0W06 100R J	0402
R515	1430762	Bottom	K	5	chip resistor	0W06 2K2 J	0402
R516	1430764	Bottom	K	5	chip resistor	0W06 3K3 J	0402
R517	1430740	Bottom	J	5	chip resistor	0W06 330R J	0402
R518	1430722	Bottom	G	5	chip resistor	0W06 68R J	0402

ITEM	CODE	SIDE	X	Y	DESCRIPTION	VALUE	TYPE
R519	1430728	Bottom	G	5	chip resistor	0W06 120R J	0402
R520	1430722	Bottom	G	5	chip resistor	0W06 68R J	0402
R521	1430758	Bottom	G	5	chip resistor	0W06 1K5 J	0402
R522	1430754	Bottom	F	5	chip resistor	0W06 1K0 J	0402
R523	1430726	Bottom	F	5	chip resistor	0W06 100R J	0402
R524	1430722	Bottom	M	3	chip resistor	0W06 68R J	0402
R525	1430726	Bottom	M	3	chip resistor	0W06 100R J	0402
R526	1430764	Bottom	M	4	chip resistor	0W06 3K3 J	0402
R527	1430742	Bottom	M	4	chip resistor	0W06 390R J	0402
R528	1430764	Bottom	M	5	chip resistor	0W06 3K3 J	0402
R529	1430762	Bottom	L	4	chip resistor	0W06 2K2 J	0402
R530	1430754	Bottom	L	4	chip resistor	0W06 1K0 J	0402
R531	1430726	Bottom	L	4	chip resistor	0W06 100R J	0402
R532	1430796	Bottom	K	3	chip resistor	0W06 47K J	0402
R533	1430796	Bottom	L	3	chip resistor	0W06 47K J	0402
R534	1430802	Bottom	M	2	chip resistor	0W06 82K J	0402
R535	1430738	Bottom	H	3	chip resistor	0W06 270R J	0402
R536	1430738	Bottom	H	3	chip resistor	0W06 270R J	0402
R537	1430690	Bottom	H	3	chip jumper	0R0	0402
R538	1430758	Bottom	J	4	chip resistor	0W06 1K5 J	0402
R601	1430778	Bottom	I	8	chip resistor	0W06 10K J	0402
R603	1430722	Bottom	H	6	chip resistor	0W06 68R J	0402
R604	1430748	Bottom	H	7	chip resistor	0W06 680R J	0402
R605	1430732	Bottom	H	7	chip resistor	0W06 180R J	0402
R606	1430778	Bottom	H	6	chip resistor	0W06 10K J	0402
R607	1820035	Bottom	G	8	NTC res	47K J B=4050+-3%	0805
R608	1430700	Bottom	J	8	chip resistor	0W06 10R J	0402
R610	1430714	Bottom	J	8	chip resistor	0W06 33 R J	0402
R611	1430772	Bottom	J	8	chip resistor	0W06 5K6 J	0402
R612	1430714	Bottom	L	8	chip resistor	0W06 33 R J	0402
R613	1430730	Bottom	L	8	chip resistor	0W06 150 R J	0402
R614	1430788	Bottom	L	8	chip resistor	0W06 22K J	0402

ITEM	CODE	SIDE	X	Y	DESCRIPTION	VALUE	TYPE
R615	1430710	Bottom	L	7	chip resistor	0W06 22R J	0402
R617	1430784	Bottom	M	8	chip resistor	0W06 15K J	0402
R619	1430756	Bottom	N	8	chip resistor	0W06 1K2 J	0402
R620	1430726	Bottom	M	7	chip resistor	0W06 100R J	0402
R622	1430812	Bottom	M	8	chip resistor	0W06 220K J	0402
R623	1430726	Bottom	F	6	chip resistor	0W06 100R J	0402
R624	1430778	Bottom	F	7	chip resistor	0W06 10K J	0402
R625	1430792	Bottom	F	7	chip resistor	0W06 33K J	0402
R626	1430740	Bottom	F	7	chip resistor	0W06 330R J	0402
R627	1430754	Bottom	F	7	chip resistor	0W06 1K0 J	0402
R628	1430792	Bottom	E	7	chip resistor	0W06 33K J	0402
R629	1430754	Bottom	K	7	chip resistor	0W06 1K0 J	0402
R701	1430681	Bottom	B	3	chip resistor	0W06 4R3 J	0402
R702	1430796	Bottom	C	2	chip resistor	0W06 47K J	0402
R705	1430722	Bottom	C	2	chip resistor	0W06 68R J	0402
R706	1430690	Bottom	O	2	chip jumper	0R0	0402
R707	1430690	Bottom	O	2	chip jumper	0R0	0402
R708	1430690	Bottom	N	3	chip jumper	0R0	0402
R709	1430690	Bottom	G	3	chip jumper	0R0	0402
R732	1430145	Bottom	Q	4	chip resistor	0W06 100K F 200ppm	0402
R733	1430778	Bottom	L	3	chip resistor	0W06 10K J	0402
R736	1430690	Top	L	2	chip jumper	0R0	0402
C100	2320552	Bottom	R	4	chip cap	NP0 47P J 50V	0402
C120	2320564	Top	P	2	chip cap	NP0 150P J 50V	0402
C122	2320552	Top	P	2	chip cap	NP0 47P J 50V	0402
C123	2320552	Top	O	2	chip cap	NP0 47P J 50V	0402
C131	2320778	Top	O	2	chip cap	X7R 10N K 16V	0402
C134	2320778	Top	O	7	chip cap	X7R 10N K 16V	0402
C135	2320778	Top	N	7	chip cap	X7R 10N K 16V	0402
C136	2320778	Top	O	7	chip cap	X7R 10N K 16V	0402
C138	2320778	Top	O	7	chip cap	X7R 10N K 16V	0402
C140	2320778	Top	O	7	chip cap	X7R 10N K 16V	0402

ITEM	CODE	SIDE	X	Y	DESCRIPTION	VALUE	TYPE
C141	2320744	Top	O	7	chip cap	X7R 1N0 K 50V	0402
C144	2320778	Top	K	8	chip cap	X7R 10N K 16V	0402
C145	2320778	Top	K	8	chip cap	X7R 10N K 16V	0402
C146	2320560	Top	O	3	chip cap	NPO 100P J 50V	0402
C150	2320783	Top	P	3	chip cap	X7R 33N K 10V	0402
C151	2320783	Top	N	3	chip cap	X7R 33N K 10V	0402
C152	2320783	Top	Q	6	chip cap	X7R 33N K 10V	0402
C153	2320783	Top	P	7	chip cap	X7R 33N K 10V	0402
C154	2320783	Top	Q	3	chip cap	X7R 33N K 10V	0402
C155	2320783	Top	O	3	chip cap	X7R 33N K 10V	0402
C160	2320783	Top	R	6	chip cap	X7R 33N K 10V	0402
C161	2320783	Top	T	6	chip cap	X7R 33N K 10V	0402
C170	2320805	Top	R	3	chip cap	X5R 100N K 10V	0402
C180	2320783	Top	O	2	chip cap	X7R 33N K 10V	0402
C201	2320783	Bottom	O	3	chip cap	X7R 33N K 10V	0402
C202	2320783	Bottom	O	3	chip cap	X7R 33N K 10V	0402
C203	2320783	Bottom	O	3	chip cap	X7R 33N K 10V	0402
C204	2320783	Bottom	O	3	chip cap	X7R 33N K 10V	0402
C205	2320783	Bottom	O	7	chip cap	X7R 33N K 10V	0402
C206	2320783	Bottom	O	7	chip cap	X7R 33N K 10V	0402
C207	2320783	Bottom	O	7	chip cap	X7R 33N K 10V	0402
C208	2320783	Bottom	O	7	chip cap	X7R 33N K 10V	0402
C210	2312211	Bottom	N	5	chip cap	X5R 3U3 K 6V3	0805
C211	2312211	Bottom	P	7	chip cap	X5R 3U3 K 6V3	0805
C212	2312211	Bottom	Q	7	chip cap	X5R 3U3 K 6V3	0805
C213	2320137	Bottom	N	5	chip cap	X5R 470N K 10V	0603
C214	2320137	Bottom	N	5	chip cap	X5R 470N K 10V	0603
C215	2320137	Bottom	N	4	chip cap	X5R 470N K 10V	0603
C216	2320764	Bottom	O	4	chip cap	X7R 6N8 K 25V	0402
C217	2320576	Bottom	P	3	chip cap	X7R 470P J 50V	0402
C218	2320560	Bottom	O	4	chip cap	NPO 100P J 50V	0402
C219	2320744	Bottom	O	4	chip cap	X7R 1N0 K 50V	0402

ITEM	CODE	SIDE	X	Y	DESCRIPTION	VALUE	TYPE
C220	2320744	Bottom	O	4	chip cap	X7R 1N0 K 50V	0402
C230	2320552	Top	N	5	chip cap	NP0 47P J 50V	0402
C231	2312211	Bottom	O	6	chip cap	X5R 3U3 K 6V3	0805
C232	2320805	Top	N	5	chip cap	X5R 100N K 10V	0402
C233	2320805	Top	N	4	chip cap	X5R 100N K 10V	0402
C234	2320805	Bottom	Q	4	chip cap	X5R 100N K 10V	0402
C240	2320139	Bottom	Q	7	chip cap	X5R 1U0 K 10V	0603
C241	2320783	Top	L	6	chip cap	X7R 33N K 10V	0402
C242	2310037	Bottom	Q	6	chip cap	X5R 10U M 6V3	0805
C243	2320560	Bottom	Q	7	chip cap	NP0 100P J 50V	0402
C244	2320552	Bottom	Q	7	chip cap	NP0 47P J 50V	0402
C245	2320552	Bottom	R	6	chip cap	NP0 47P J 50V	0402
C246	2320584	Bottom	S	6	chip cap	X7R 1N0 J 50V	0402
C247	2320584	Bottom	T	6	chip cap	X7R 1N0 J 50V	0402
C248	2320584	Bottom	S	6	chip cap	X7R 1N0 J 50V	0402
C249	2320584	Bottom	T	6	chip cap	X7R 1N0 J 50V	0402
C250	2310037	Bottom	Q	6	chip cap	X5R 10U M 6V3	0805
C251	2320560	Bottom	Q	6	chip cap	NP0 100P J 50V	0402
C252	2320552	Bottom	R	7	chip cap	NP0 47P J 50V	0402
C253	2320552	Bottom	R	6	chip cap	NP0 47P J 50V	0402
C255	2312211	Bottom	P	8	chip cap	X5R 3U3 K 6V3	0805
C260	2320805	Bottom	P	6	chip cap	X5R 100N K 10V	0402
C261	2320552	Bottom	P	7	chip cap	NP0 47P J 50V	0402
C262	2320552	Bottom	Q	6	chip cap	NP0 47P J 50V	0402
C263	2320552	Bottom	O	6	chip cap	NP0 47P J 50V	0402
C264	2320552	Bottom	Q	6	chip cap	NP0 47P J 50V	0402
C265	2320139	Bottom	P	8	chip cap	X5R 1U0 K 10V	0603
C270	2320805	Bottom	P	6	chip cap	X5R 100N K 10V	0402
C271	2320552	Bottom	P	6	chip cap	NP0 47P J 50V	0402
C272	2320552	Bottom	Q	5	chip cap	NP0 47P J 50V	0402
C280	2320552	Bottom	O	6	chip cap	NP0 47P J 50V	0402
C281	2320552	Bottom	P	7	chip cap	NP0 47P J 50V	0402

ITEM	CODE	SIDE	X	Y	DESCRIPTION	VALUE	TYPE
C282	2320552	Bottom	P	7	chip cap	NPO 47P J 50V	0402
C283	2320805	Bottom	P	7	chip cap	X5R 100N K 10V	0402
C284	2320805	Bottom	P	7	chip cap	X5R 100N K 10V	0402
C285	2320552	Bottom	P	8	chip cap	NPO 47P J 50V	0402
C286	2320552	Bottom	P	8	chip cap	NPO 47P J 50V	0402
C290	2320552	Bottom	P	6	chip cap	NPO 47P J 50V	0402
C291	2320552	Top	B	7	chip cap	NPO 47P J 50V	0402
C292	2320552	Top	B	7	chip cap	NPO 47P J 50V	0402
C300	2310791	Bottom	R	2	chip cap	X7R 33N M 50V	0805
C301	2320131	Bottom	P	3	chip cap	X7R 33N K 16 V	0603
C310	2320139	Bottom	Q	4	chip cap	X5R 1U0 K 10V	0603
C311	2312255	Top	L	3	chip cap	X5R 10U K 10V	1206
C312	2320779	Bottom	P	2	chip cap	X7R 100N K 16V	0603
C315	2312203	Bottom	R	3	chip cap	Y5V 1U Z 50V	0805
C316	2320778	Top	N	3	chip cap	X7R 10N K 16V	0402
C320	2320538	Top	N	6	chip cap	NPO 12P J 50V	0402
C321	2320548	Top	M	6	chip cap	NPO 33P J 50V	0402
C324	2320518	Top	M	6	chip cap	NPO 1P8 C 50V	0402
C325	2320139	Top	M	4	chip cap	X5R 1U0 K 10V	0603
C330	2312255	Top	L	2	chip cap	X5R 10U K 10V	1206
C331	2320544	Top	L	6	chip cap	NPO 22P J 50V	0402
C332	2320544	Top	M	6	chip cap	NPO 22P J 50V	0402
C350	2320139	Top	L	4	chip cap	X5R 1U0 K 10V	0603
C351	2320139	Top	L	4	chip cap	X5R 1U0 K 10V	0603
C352	2320139	Top	K	5	chip cap	X5R 1U0 K 10V	0603
C353	2320139	Top	K	5	chip cap	X5R 1U0 K 10V	0603
C354	2320139	Top	K	5	chip cap	X5R 1U0 K 10V	0603
C355	2320139	Top	K	5	chip cap	X5R 1U0 K 10V	0603
C356	2320139	Top	L	4	chip cap	X5R 1U0 K 10V	0603
C357	2320139	Top	N	5	chip cap	X5R 1U0 K 10V	0603
C358	2320139	Top	L	7	chip cap	X5R 1U0 K 10V	0603
C359	2320139	Top	N	6	chip cap	X5R 1U0 K 10V	0603

ITEM	CODE	SIDE	X	Y	DESCRIPTION	VALUE	TYPE
C360	2320139	Top	M	4	chip cap	X5R 1U0 K 10V	0603
C370	2310793	Top	N	5	chip cap	X5R 2U2 K 10V	0805
C371	2310793	Top	M	3	chip cap	X5R 2U2 K 10V	0805
C372	2310793	Top	N	3	chip cap	X5R 2U2 K 10V	0805
C373	2310793	Top	N	4	chip cap	X5R 2U2 K 10V	0805
C374	2310793	Top	N	3	chip cap	X5R 2U2 K 10V	0805
C375	2320139	Top	K	4	chip cap	X5R 1U0 K 10V	0603
C380	2320139	Top	M	4	chip cap	X5R 1U0 K 10V	0603
C430	2320805	Bottom	E	5	chip cap	X5R 100N K 10V	0402
C431	2320805	Bottom	E	5	chip cap	X5R 100N K 10V	0402
C432	2320139	Bottom	E	5	chip cap	X5R 1U0 K 10V	0603
C433	2320139	Bottom	E	4	chip cap	X5R 1U0 K 10V	0603
C434	2320139	Bottom	E	4	chip cap	X5R 1U0 K 10V	0603
C435	2320139	Bottom	E	3	chip cap	X5R 1U0 K 10V	0603
C440	2320560	Top	Q	7	chip cap	NPO 100P J 50V	0402
C441	2320560	Top	Q	7	chip cap	NPO 100P J 50V	0402
C442	2320560	Top	P	7	chip cap	NPO 100P J 50V	0402
C443	2320560	Top	Q	7	chip cap	NPO 100P J 50V	0402
C444	2320560	Top	P	7	chip cap	NPO 100P J 50V	0402
C445	2320560	Top	Q	7	chip cap	NPO 100P J 50V	0402
C446	2320560	Top	Q	7	chip cap	NPO 100P J 50V	0402
C447	2320560	Top	P	7	chip cap	NPO 100P J 50V	0402
C448	2320560	Top	O	7	chip cap	NPO 100P J 50V	0402
C449	2320560	Top	P	7	chip cap	NPO 100P J 50V	0402
C450	2320552	Top	B	7	chip cap	NPO 47P J 50V	0402
C460	2320139	Top	K	7	chip cap	X5R 1U0 K 10V	0603
C471	2320552	Bottom	E	2	chip cap	NPO 47P J 50V	0402
C472	2320552	Bottom	D	2	chip cap	NPO 47P J 50V	0402
C473	2320552	Bottom	D	2	chip cap	NPO 47P J 50V	0402
C501	2320544	Bottom	H	3	chip cap	NPO 22P J 50V	0402
C502	2310037	Bottom	G	4	chip cap	X5R 10U M 6V3	0805
C503	2320544	Bottom	H	3	chip cap	NPO 22P J 50V	0402

ITEM	CODE	SIDE	X	Y	DESCRIPTION	VALUE	TYPE
C504	2320584	Bottom	I	3	chip cap	X7R 1N0 J 50V	0402
C505	2310037	Bottom	G	3	chip cap	X5R 10U M 6V3	0805
C506	2320536	Bottom	G	3	chip cap	NP0 10P J 50V	0402
C507	2320584	Bottom	G	3	chip cap	X7R 1N0 J 50V	0402
C508	2420015	Bottom	I	4	chip cap	PPS 47N J 16V	1206
C509	2320618	Bottom	I	5	chip cap	X7R 4N7 J 25V	0402
C510	2320805	Bottom	I	4	chip cap	X5R 100N K 10V	0402
C511	2320544	Bottom	I	4	chip cap	NP0 22P J 50V	0402
C512	2320552	Bottom	I	5	chip cap	NP0 47P J 50V	0402
C513	2320584	Bottom	J	3	chip cap	X7R 1N0 J 50V	0402
C514	2310037	Bottom	J	3	chip cap	X5R 10U M 6V3	0805
C515	2320576	Bottom	J	5	chip cap	X7R 470P J 50V	0402
C516	2320560	Bottom	J	5	chip cap	NP0 100P J 50V	0402
C517	2320544	Bottom	J	4	chip cap	NP0 22P J 50V	0402
C518	2320805	Bottom	J	4	chip cap	X5R 100N K 10V	0402
C519	2320548	Bottom	I	5	chip cap	NP0 33P J 50V	0402
C520	2320805	Bottom	J	4	chip cap	X5R 100N K 10V	0402
C521	2320805	Bottom	J	4	chip cap	X5R 100N K 10V	0402
C522	2320805	Bottom	J	4	chip cap	X5R 100N K 10V	0402
C523	2320805	Bottom	J	4	chip cap	X5R 100N K 10V	0402
C524	2320778	Bottom	J	5	chip cap	X7R 10N K 16V	0402
C525	2320805	Bottom	J	4	chip cap	X5R 100N K 10V	0402
C526	2320586	Bottom	J	4	chip cap	X7R 1N2 J 50V	0402
C527	2320481	Bottom	M	3	chip cap	X5R 1U K 6V3	0603
C528	2320584	Bottom	M	2	chip cap	X7R 1N0 J 50V	0402
C529	2320481	Bottom	K	5	chip cap	X5R 1U K 6V3	0603
C530	2320576	Bottom	K	5	chip cap	X7R 470P J 50V	0402
C531	2320604	Bottom	K	5	chip cap	NP0 18P J 50V	0402
C532	2320552	Bottom	K	5	chip cap	NP0 47P J 50V	0402
C533	2320538	Bottom	K	5	chip cap	NP0 12P J 50V	0402
C534	2320544	Bottom	K	5	chip cap	NP0 22P J 50V	0402
C535	2320560	Bottom	K	5	chip cap	NP0 100P J 50V	0402

ITEM	CODE	SIDE	X	Y	DESCRIPTION	VALUE	TYPE
C536	2320520	Bottom	L	6	chip cap	NPO 2P2 C 50V	0402
C537	2320532	Bottom	L	6	chip cap	NPO 6P8 C 50V	0402
C538	2320532	Bottom	L	6	chip cap	NPO 6P8 C 50V	0402
C539	2320548	Bottom	L	3	chip cap	NPO 33P J 50V	0402
C540	2320560	Bottom	M	4	chip cap	NPO 100P J 50V	0402
C541	2320481	Bottom	L	4	chip cap	X5R 1U K 6V3	0603
C542	2320618	Bottom	L	4	chip cap	X7R 4N7 J 25V	0402
C543	2320805	Bottom	L	4	chip cap	X5R 100N K 10V	0402
C544	2320564	Bottom	L	4	chip cap	NPO 150P J 50V	0402
C545	2320544	Bottom	M	4	chip cap	NPO 22P J 50V	0402
C546	2320481	Bottom	M	3	chip cap	X5R 1U K 6V3	0603
C547	2320540	Bottom	M	4	chip cap	NPO 15P J 50V	0402
C548	2320544	Bottom	M	5	chip cap	NPO 22P J 50V	0402
C549	2320550	Bottom	M	4	chip cap	NPO 39P J 50V	0402
C550	2320481	Bottom	L	4	chip cap	X5R 1U K 6V3	0603
C551	2320584	Bottom	M	3	chip cap	X7R 1N0 J 50V	0402
C552	2320584	Bottom	M	4	chip cap	X7R 1N0 J 50V	0402
C553	2320544	Bottom	G	5	chip cap	NPO 22P J 50V	0402
C554	2320544	Bottom	F	5	chip cap	NPO 22P J 50V	0402
C555	2320544	Bottom	F	4	chip cap	NPO 22P J 50V	0402
C556	2320481	Bottom	F	5	chip cap	X5R 1U K 6V3	0603
C557	2320584	Bottom	F	5	chip cap	X7R 1N0 J 50V	0402
C601	2320584	Bottom	K	7	chip cap	X7R 1N0 J 50V	0402
C602	2320536	Bottom	K	7	chip cap	NPO 10P J 50V	0402
C603	2320536	Bottom	I	7	chip cap	NPO 10P J 50V	0402
C604	2320536	Bottom	I	7	chip cap	NPO 10P J 50V	0402
C605	2320620	Bottom	I	7	chip cap	X7R 10N J 16V	0402
C606	2320576	Bottom	I	7	chip cap	X7R 470P J 50V	0402
C607	2320576	Bottom	H	6	chip cap	X7R 470P J 50V	0402
C608	2320536	Bottom	H	8	chip cap	NPO 10P J 50V	0402
C609	2320536	Bottom	I	8	chip cap	NPO 10P J 50V	0402
C610	2320536	Bottom	H	8	chip cap	NPO 10P J 50V	0402

ITEM	CODE	SIDE	X	Y	DESCRIPTION	VALUE	TYPE
C611	2320536	Bottom	I	8	chip cap	NPO 10P J 50V	0402
C612	2312255	Bottom	G	6	chip cap	X5R 10U K 10V	1206
C613	2312255	Bottom	G	6	chip cap	X5R 10U K 10V	1206
C614	2320536	Bottom	H	8	chip cap	NPO 10P J 50V	0402
C615	2320536	Bottom	F	7	chip cap	NPO 10P J 50V	0402
C617	2320538	Bottom	I	8	chip cap	NPO 12P J 50V	0402
C618	2320602	Bottom	J	7	chip cap	NPO 4P7 C 50V	0402
C619	2320538	Bottom	J	8	chip cap	NPO 12P J 50V	0402
C620	2320805	Bottom	J	8	chip cap	X5R 100N K 10V	0402
C621	2320524	Bottom	J	8	chip cap	NPO 3P3 C 50V	0402
C622	2320518	Bottom	K	8	chip cap	NPO 1P8 C 50V	0402
C623	2320534	Bottom	K	7	chip cap	NPO 8P2 C 50V	0402
C624	2320584	Bottom	J	7	chip cap	X7R 1N0 J 50V	0402
C625	2320534	Bottom	K	7	chip cap	NPO 8P2 C 50V	0402
C626	2320518	Bottom	K	8	chip cap	NPO 1P8 C 50V	0402
C627	2320785	Bottom	L	8	chip cap	X7R 47N K 10V	0402
C628	2320584	Bottom	L	8	chip cap	X7R 1N0 J 50V	0402
C629	2320544	Bottom	K	8	chip cap	NPO 22P J 50V	0402
C630	2320584	Bottom	L	8	chip cap	X7R 1N0 J 50V	0402
C631	2320785	Bottom	L	8	chip cap	X7R 47N K 10V	0402
C634	2320584	Bottom	M	8	chip cap	X7R 1N0 J 50V	0402
C636	2320783	Bottom	K	7	chip cap	X7R 33N K 10V	0402
C637	2320538	Bottom	F	8	chip cap	NPO 12P J 50V	0402
C638	2320526	Bottom	M	8	chip cap	NPO 3P9 C 50V	0402
C639	2320805	Bottom	I	8	chip cap	X5R 100N K 10V	0402
C641	2320520	Bottom	M	8	chip cap	NPO 2P2 C 50V	0402
C642	2320520	Bottom	L	8	chip cap	NPO 2P2 C 50V	0402
C643	2320778	Bottom	M	7	chip cap	X7R 10N K 16V	0402
C644	2320778	Bottom	N	8	chip cap	X7R 10N K 16V	0402
C645	2320744	Top	N	7	chip cap	X7R 1N0 K 50V	0402
C647	2320744	Top	N	7	chip cap	X7R 1N0 K 50V	0402
C649	2320744	Bottom	M	8	chip cap	X7R 1N0 K 50V	0402

ITEM	CODE	SIDE	X	Y	DESCRIPTION	VALUE	TYPE
C650	2320744	Bottom	N	7	chip cap	X7R 1N0 K 50V	0402
C652	2320744	Bottom	O	7	chip cap	X7R 1N0 K 50V	0402
C654	2320584	Bottom	F	6	chip cap	X7R 1N0 J 50V	0402
C655	2320544	Bottom	F	6	chip cap	NP0 22P J 50V	0402
C656	2320544	Bottom	F	7	chip cap	NP0 22P J 50V	0402
C657	2320544	Bottom	F	7	chip cap	NP0 22P J 50V	0402
C658	2320524	Bottom	F	7	chip cap	NP0 3P3 C 50V	0402
C659	2320620	Bottom	E	6	chip cap	X7R 10N J 16V	0402
C660	2320584	Bottom	E	7	chip cap	X7R 1N0 J 50V	0402
C661	2320538	Bottom	J	7	chip cap	NP0 12P J 50V	0402
C662	2320538	Bottom	I	6	chip cap	NP0 12P J 50V	0402
C701	2320520	Bottom	C	8	chip cap	NP0 2P2 C 50V	0402
C702	2320560	Bottom	B	2	chip cap	NP0 100P J 50V	0402
C704	2320538	Bottom	C	3	chip cap	NP0 12P J 50V	0402
C705	2320785	Bottom	D	3	chip cap	X7R 47N K 10V	0402
C706	2320744	Bottom	C	2	chip cap	X7R 1N0 K 50V	0402
C707	2320602	Bottom	D	2	chip cap	NP0 4P7 C 50V	0402
C708	2320508	Bottom	B	3	chip cap	NP0 1P0 C 50V	0402
C709	2320805	Bottom	B	3	chip cap	X5R 100N K 10V	0402
C710	2320538	Bottom	B	3	chip cap	NP0 12P J 50V	0402
C711	2320909	Bottom	G	2	chip cap	NP0 HQ 1P0 B 16V	0402
C712	2320596	Bottom	G	2	chip cap	X7R 3N3 J 50V	0402
C713	2320805	Bottom	G	2	chip cap	X5R 100N K 10V	0402
C714	2320550	Bottom	G	2	chip cap	NP0 39P J 50V	0402
C715	2320520	Bottom	J	2	chip cap	NP0 2P2 C 50V	0402
C716	2320548	Bottom	J	2	chip cap	NP0 33P J 50V	0402
C717	2320548	Bottom	J	2	chip cap	NP0 33P J 50V	0402
C718	2320760	Bottom	N	3	chip cap	X7R 4N7 K 25V	0402
C720	2320538	Bottom	O	2	chip cap	NP0 12P J 50V	0402
C721	2320538	Bottom	N	3	chip cap	NP0 12P J 50V	0402
C722	2320538	Bottom	N	2	chip cap	NP0 12P J 50V	0402
C723	2320744	Bottom	M	2	chip cap	X7R 1N0 K 50V	0402

ITEM	CODE	SIDE	X	Y	DESCRIPTION	VALUE	TYPE
C724	2320778	Bottom	N	3	chip cap	X7R 10N K 16V	0402
C726	2320538	Bottom	M	2	chip cap	NP0 12P J 50V	0402
C766	2320560	Bottom	D	2	chip cap	NP0 100P J 50V	0402
L050	3203701	Bottom	R	2	ferrite bead	33R/100MHz	0805
L230	3203701	Top	N	4	ferrite bead	33R/100MHz	0805
L300	3203701	Top	K	2	ferrite bead	33R/100MHz	0805
L301	3203701	Bottom	R	4	ferrite bead	33R/100MHz	0805
L302	3203701	Top	K	2	ferrite bead	33R/100MHz	0805
L501	3645185	Bottom	F	5	chip coil	10N J Q12/100MHz	0603
L502	3203709	Bottom	K	5	ferrite bead	0.5R 120R/100M	0402
L503	3645245	Bottom	K	4	chip coil	6N8 J Q27/250MHz	0603
L504	3646061	Bottom	L	6	chip coil	15N J Q30/800MHz	0402
L505	3645217	Bottom	M	4	chip coil	15N J Q35/250MHz	0603
L506	3645185	Bottom	M	3	chip coil	10N J Q12/100MHz	0603
L507	3203709	Bottom	L	4	ferrite bead	0.5R 120R/100M	0402
L508	3646009	Bottom	F	4	chip coil	10N J Q30/800MHz	0402
L601	3646085	Bottom	I	8	chip coil	6N8 K Q29/800MHz	0402
L602	3646009	Bottom	J	8	chip coil	10N J Q30/800MHz	0402
L603	3646051	Bottom	J	8	chip coil	3N9+-0N3 Q28/800M	0402
L604	3646085	Bottom	K	8	chip coil	6N8 K Q29/800MHz	0402
L605	3646047	Bottom	J	8	chip coil	3N3+-0N3 Q28/800M	0402
L606	3646051	Bottom	K	8	chip coil	3N9+-0N3 Q28/800M	0402
L607	3646067	Bottom	L	7	chip coil	18N J Q29/800MHz	0402
L608	3646081	Bottom	L	8	chip coil	68N J Q17/300MHz	0402
L609	3646081	Bottom	L	7	chip coil	68N J Q17/300MHz	0402
L610	3646005	Bottom	J	8	chip coil	2N7 +-0N3 Q29/ 800M	0402
L614	3645343	Bottom	M	8	chip coil	150N J Q28/150MHz	0603
L615	3645319	Bottom	M	8	chip coil	220N J Q25/100MHz	0603
L616	3645157	Bottom	N	6	chip coil	100N K Q12/100MHz	0603
L617	3645157	Bottom	O	8	chip coil	100N K Q12/100MHz	0603
L619	3645185	Bottom	F	6	chip coil	10N J Q12/100MHz	0603
L701	3646053	Bottom	C	2	chip coil	4N7+-0N3 Q28/800M	0402

ITEM	CODE	SIDE	X	Y	DESCRIPTION	VALUE	TYPE
L702	3646077	Bottom	D	2	chip coil	82N J Q17/300MHz	0402
L703	3646405	Bottom	C	3	chip coil	6N8 K Q29/800MHz	0402
L704	3646417	Bottom	C	8	chip coil	5N6 J Q20 0R083	040
L705	3645301	Bottom	D	3	chip coil	180N J Q13/100MHz	0603
L706	3646047	Bottom	C	3	chip coil	3N3+-0N3 Q28/800M	0402
L707	3645195	Bottom	G	2	chip coil	82N J Q12/100MHz	0603
L708	3645201	Bottom	J	2	chip coil	56NH J Q38/200MHz	0603
L709	3645229	Bottom	J	2	chip coil	120N J Q32/150MHz	0603
L710	3645229	Bottom	J	2	chip coil	120N J Q32/150MHz	0603
Z100	3640035	Bottom	R	4	filt Z>450R/100M	0R7MAX 0.2A	0603
Z240	3640035	Bottom	R	6	filt Z>450R/100M	0R7MAX 0.2A	0603
Z250	3640035	Bottom	R	6	filt Z>450R/100M	0R7MAX 0.2A	0603
Z600	4511023	Bottom	J	6	Saw Filt	1880+-30MHz/4.2DB	3X3
Z602	4511331	Bottom	I	8	Dual Saw Filt	1850-1885/1875-1910	
Z702	4511333	Bottom	B	3	Saw Filt	1960+-30MHz/3.1	2X2X0.8
Z703	4511329	Bottom	H	2	Saw Filt	128.1+-0.61MHz	9X5X1.6
V050	4113669	Bottom	R	5	ZDIX4 TVS/ESD	RSA6.1EN 6V1	SOT353
V051	4113669	Bottom	R	5	ZDIX4 TVS/ESD	RSA6.1EN 6V1	SOT353
V280	4210100	Bottom	Q	8	TR BC848W	N 30V 0.1A100MHz	SOT323
V281	4210049	Bottom	Q	8	TR PDTC114EE	N50V RB=RBE=10K	SC75
V290	4113669	Top	C	7	ZDIX4 TVS/ESD	RSA6.1EN 6V1	SOT353
V300	4210049	Bottom	P	4	TR PDTC114EE	N50V RB=RBE=10K	SC75
V310	4210102	Top	L	3	TR BC858W		
V370	4110441	Top	N	4	sch di STPS0520Z	20V 0.5A	SOD123
V400	4110601	Top	C	7	di fast 1SS355	80V0.1A<4NS	SOD 323
V410	4110601	Bottom	Q	7	di fast 1SS355	80V0.1A<4NS	SOD 323
V420	4864551	Top	I	2	LED CL191B1	BLUE468NM VF>3V5	0603
V421	4864551	Top	F	8	LED CL191B1	BLUE468NM VF>3V5	0603
V422	4864551	Top	H	8	LED CL191B1	BLUE468NM VF>3V5	0603
V423	4864551	Top	I	8	LED CL191B1	BLUE468NM VF>3V5	0603
V424	4864551	Top	F	2	LED CL191B1	BLUE468NM VF>3V5	0603
V425	4864551	Top	H	2	LED CL191B1	BLUE468NM VF>3V5	0603

ITEM	CODE	SIDE	X	Y	DESCRIPTION	VALUE	TYPE
V450	4110601	Top	O	8	di fast 1SS355	80V0.1A<4NS	SOD 323
V501	4210074	Bottom	F	5	TR BFP420 N	4.5V35MA 20GHz	SOT343
V502	4210066	Bottom	K	5	TR BFR93AW	N 12V 35MA 5GHz	SOT323
V503	4210066	Bottom	M	4	TR BFR93AW	N 12V 35MA 5GHz	SOT323
V504	4110921	Bottom	J	5	cap.di BBY57-	02W 1/4 16/4P	SOD523
V505	4110026	Bottom	L	5	cap di 1SV229	15/6 PF 2/10V	SOD323
V601	4219937	Bottom	G	7	TRX2 UMT1/PUMT	P40V100MZ	SOT363
V602	4210049	Bottom	G	6	TR PDTC114EE	N50V RB=RBE=10K	SC75
V603	4110008	Bottom	F	7	sch di HSMS2825	1PF VF0.34	SOT143
V604	4210066	Bottom	L	8	TR BFR93AW	N 12V 35MA 5GHz	SOT323
V605	4210074	Bottom	J	8	TR BFP420 N	4.5V35MA 20GHz	SOT343
D100	4375015	Top	P	5	MAD4 V14	F741718B C05	UBGA176
D130	4340126	Top	O	7	TC7S00F	1XNAND 2INPUT CMOS	SS05
D140	4340183	Top	O	7	TC7SLO8FU	1XAND 2 INPUT 1V	SOT353
D160	4341281	Top	S	6	FLASH 2MX16	100NS 2.7V	TFBGA47
D170	4341161	Top	S	4	SRAM 512KX8	70NS 2.7-3.3V	TBGA48
D180	4341633	Top	M	2	EEPROM 128KX8	10MS 2.7V	LGA8
D200	4370715	Bottom	P	5	CAFE_D ASIC for	CDMA	LFBGA12 0
G501	4350181	Bottom	H	4	VCO 2045- 2135MHZ	2.7V CDMA	
G502	4510347	Bottom	L	2	VCTCXO 19.2MHZ	+/-1.5PPM 2.7V	
N270	4340861	Bottom	Q	5	1XOP AMP	2.7-5.5V (LMV321)	SC70-5
N301	4370621	Bottom	Q	3	CHAPS V2.0	U423V20G36T	LBGA6X6
N302	4370721	Top	L	5	CCONT 2M	WFD163ME64T/8	TFBGA8X 8
N420	4370433	Top	L	8	UISwitch	STTM23AV20T	TSSOP20
N431	4340871	Bottom	D	6	REG 1.8V/150MA	(MC78PC18)	SOT23-5
N501	4341075	Bottom	J	5	2XSUNT 2.5G/ 510M	(LMX2330L)	LPCC24
N502	4340809	Bottom	L	3	MB15C130 PLL	SYNTH 256.2MHz	BCC16
N601	4340473	Bottom	J	7	AT118 VAR ATTN	.5-2GHz 15DB	MSOP8
N602	4370887	Bottom	I	7	Hornet RF2357E7	PCS Driver AMP	

ITEM	CODE	SIDE	X	Y	DESCRIPTION	VALUE	TYPE
N603	4341149	Bottom	I	8	Switch SPDT GAAS	(SW-437)	SC70-6
N604	4350339	Bottom	G	8	PW AMP	1850-1910MHz Snapper CDMA	
N605	4341337	Bottom	K	8	CMY211 Mixer+LO	-Buffer 2.5GHz	MW6
N606	4370607	Bottom	N	7	TIF	WFD165AG36T/6	BGA36
N701	4370893	Bottom	C	3	LNA/MIXER/ DOWNCON- VERTER	VQFN-24 R	
N702	4370331	Bottom	N	2	RIF	WFD175AG36T/6	BGA36
F300	5119019	Bottom	R	4	SM Fuse F 1.5A	32V	0603
B320	4510219	Top	M	6	Crystal	32.768KHz+-30ppm	9PF
B400	5140157	Top	C	3	Buzzer	85DB 3000Hz 3.0V 8.5X8.5X3	
S450	5209001	Top	B	7	SM SW Tact SPST	12V 50MA Side Key	
X460	5469081	Top	Q	8	SM Conn 2X7M	P0.5 SPR.50V PCB/ PCB	
X702	5429021	Top	C	8	SM Conn RF+SW	100V 1W 50R 2.2GHz	
A410	9854352	Bottom	S	7	PCB UX7V	4.5X4.5X1.6 D	140/PA
A701	9517189	Bottom	C	5	RF-CAN Assy	DMC04944 Duplrx Shld	